



MMF300YB050U

500V 300A FRED Module

RoHS Compliant

March 2010

PRELIMINARY

PRODUCT FEATURES

- Ultrafast Reverse Recovery Time
- Soft Reverse Recovery Characteristics
- Low Reverse Recovery Loss
- Low Forward Voltage
- High Surge Current Capability
- Low Inductance Package



APPLICATIONS

- Inversion Welder
- Uninterruptible Power Supply (UPS)
- Plating Power Supply
- Ultrasonic Cleaner and Welder
- Converter & Chopper
- Power Factor Correction (PFC) Circuit

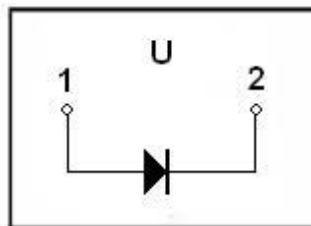

ABSOLUTE MAXIMUM RATINGS

T_C=25°C unless otherwise specified

Symbol	Parameter	Test Conditions	Values	Unit
V _R	Maximum D.C. Reverse Voltage		500	V
V _{RRM}	Maximum Repetitive Reverse Voltage		500	V
I _{F(AV)}	Average Forward Current	T _C =110°C	300	A
I _{F(RMS)}	RMS Forward Current	T _C =110°C	420	A
I _{FSM}	Non-Repetitive Surge Forward Current	1/2 Cycle , 50Hz, Sine	5000	A
		1/2 Cycle , 60Hz, Sine	5500	A
I ² t	I ² t (For Fusing)	T _J =45°C, t=10ms, 50Hz, Sine	125000	A ² s
		T _J =45°C, t=8.3ms, 60Hz, Sine	151250	A ² s
P _D	Power Dissipation		1136	W
T _J	Junction Temperature		-40 to +150	°C
T _{STG}	Storage Temperature Range		-40 to +125	°C
Torque	Module-to-Sink	Recommended (M6)	3~4.7	N·m
Torque	Module Electrodes	Recommended (M6)	3~4.7	N·m
R _{θJC}	Thermal Resistance	Junction-to-Case	0.11	°C /W
Weight			133	g

MacMic Science & Technology Co., Ltd.

Add: #18, Hua Shan Zhong Lu, New District, Changzhou City, Jiangsu Province, P. R .of China

Tel.: +86-519-85163708 Fax: +86-519-85162291 Post Code: 213022 Website: www.macmicst.com

ELECTRICAL CHARACTERISTICS

T_C=25°C unless otherwise specified

Symbol	Parameter	Test Conditions	Min.	Typ.	Max.	Unit
I _{RM}	Reverse Leakage Current	V _R =500V	--	--	0.5	mA
		V _R =500V, T _J =125°C	--	--	5	mA
V _F	Forward Voltage	I _F =300A	--	1.2	1.40	V
		I _F =300A, T _J =125°C	--	--	1.25	V
t _{rr}	Reverse Recovery Time	I _F =1A, V _R =30V, di _F /dt=-200A/μs	--	68	--	ns
t _{rr}	Reverse Recovery Time	V _R =250V, I _F =300A	--	160	--	ns
I _{RRM}	Max. Reverse Recovery Current	di _F /dt=-200A/μs, T _J =25°C	--	15	--	A
t _{rr}	Reverse Recovery Time	V _R =250V, I _F =300A	--	340	--	ns
I _{RRM}	Max. Reverse Recovery Current	di _F /dt=-200A/μs, T _J =125°C	--	34	--	A

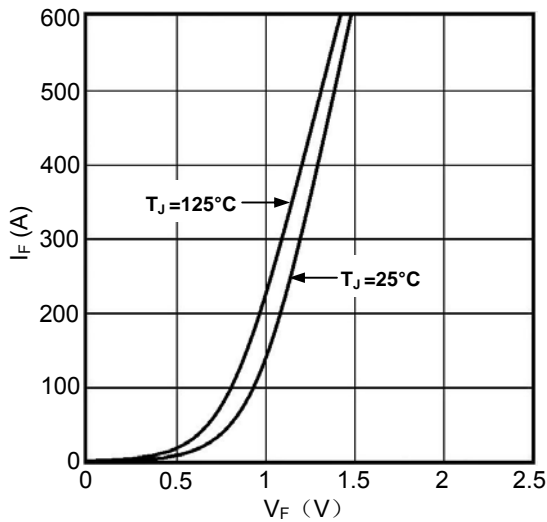

Figure1. Forward Voltage Drop vs Forward Current

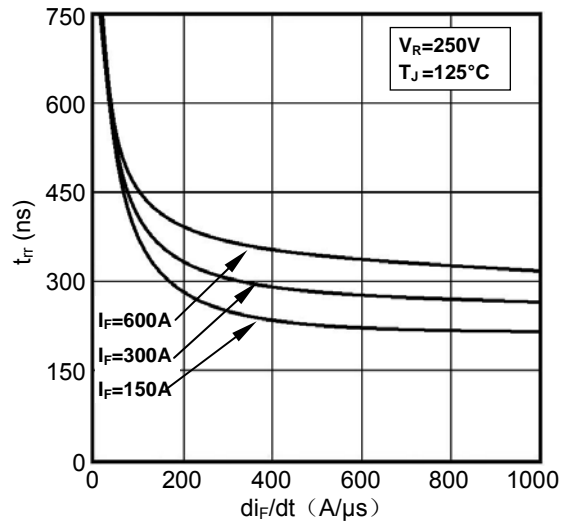

Figure2. Reverse Recovery Time vs di_F/dt

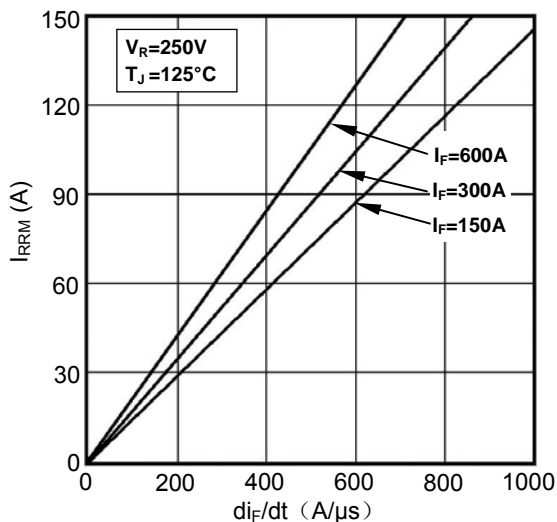

Figure3. Reverse Recovery Current vs di_F/dt

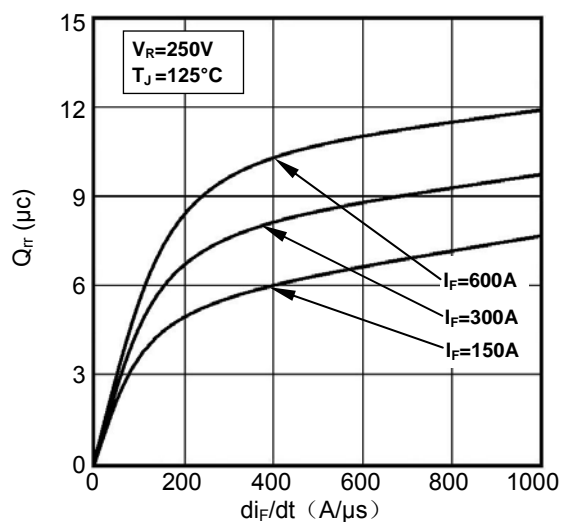

Figure4. Reverse Recovery Charge vs di_F/dt

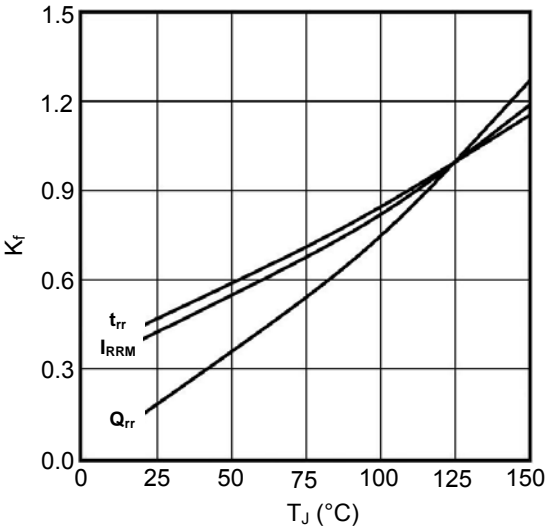

Figure5. Dynamic Parameters vs Junction Temperature

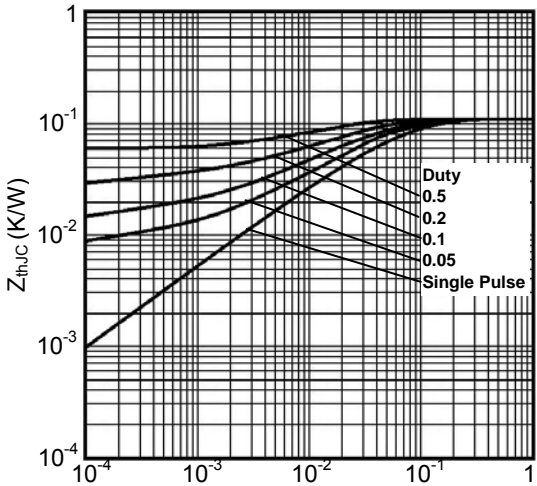
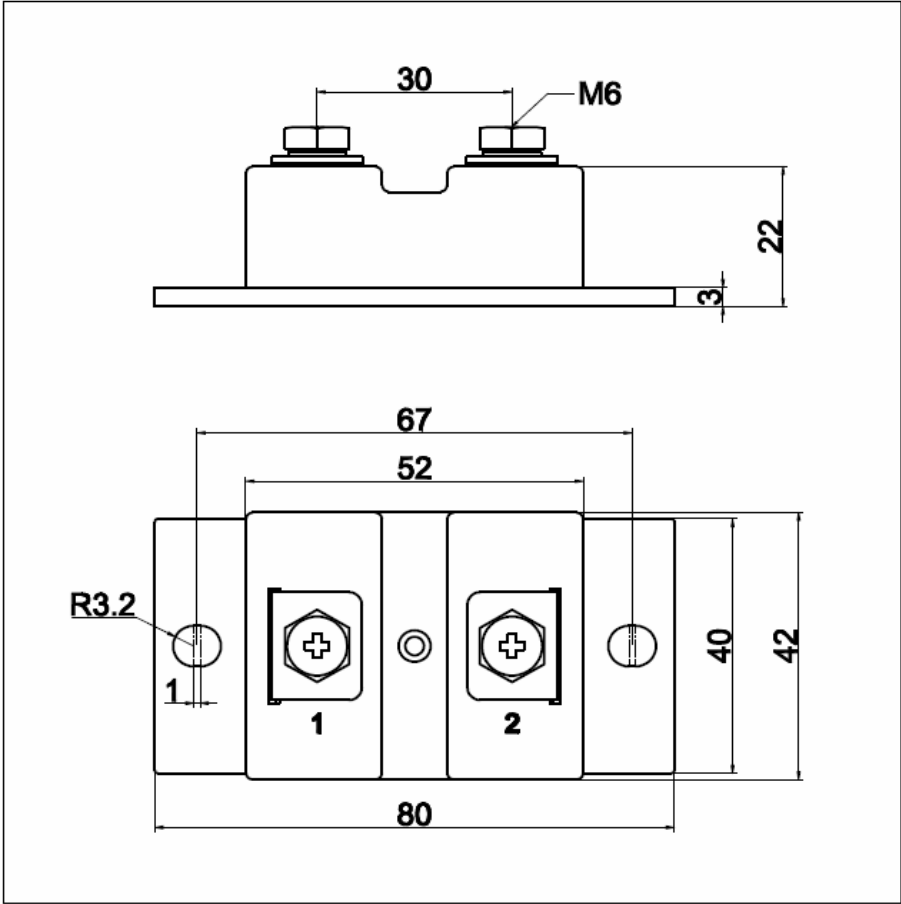

Figure6. Transient Thermal Impedance



Dimensions (mm)
Figure7. Package Outline